

# User manual

5 in 1 blend and prep

---



## Description of parts

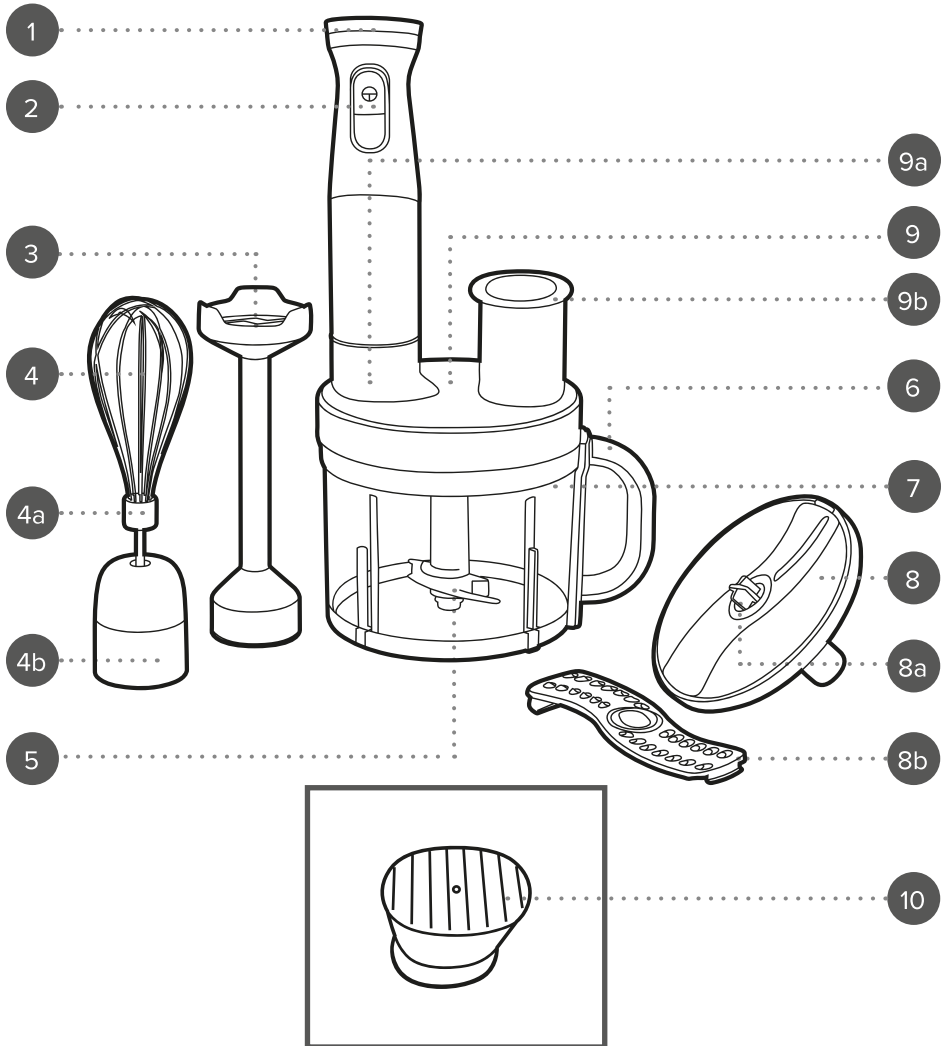

1. Blender unit
2. 2 speed buttons
3. Blender attachment
4. Whisk attachment
  - 4a. Removable whisk
  - 4b. Whisk coupling unit
5. Chopping blade
6. Processor bowl handle

7. Processor bowl
8. Blade disc
  - 8a. Slicing blade tool
  - 8b. Shredding blade tool
9. Processor bowl lid
  - 9a. Coupling for blender unit
  - 9b. Feeding chute
10. Food pusher

Please retain instructions for future reference.

## **SAFETY INSTRUCTIONS**

- When using electrical appliances, basic safety precautions should always be followed.
- Check that the voltage indicated on the rating plate corresponds with that of the local network before connecting the appliance to the mains power supply.
- Children aged from 8 years and people with reduced physical, sensory or mental capabilities or lack of experience and knowledge can use this appliance, only if they have been given supervision or instruction concerning use of the appliance in a safe way and understand the hazards involved.
- Children should be supervised to ensure that they do not play with the appliance.
- Unless they are older than 8 and supervised, children should not perform cleaning or user maintenance.
- This appliance is not a toy.
- If the power supply cord, plug or any part of the appliance is malfunctioning or if it has been dropped or damaged, cease using the product immediately to avoid potential injury.
- This appliance contains no user serviceable parts, only a qualified electrician should carry out repairs.
- Improper repairs may place the user at risk of harm.
- Keep the appliance out of the reach of children when it is switched on or cooling down.
- Keep the appliance and its power supply cord out of the reach of children.
- Keep the appliance out of the reach of children when it is switched on or cooling down.
- Keep the appliance and its power supply cord away from heat or sharp edges that could cause damage.
- Keep the appliance away from other heat emitting appliances.
- Keep hands, fingers, hair and any loose clothing away from the rotating tools of the appliance.
- Do not immerse the electrical components of this appliance in water or any other liquid.
- Do not operate the appliance with wet hands.
- Do not leave the appliance unattended whilst connected to the mains power supply.
- Do not remove the appliance from the mains power supply by pulling the cord; switch it off and remove the plug by hand.
- Do not pull or carry the appliance by its power supply cord.
- Do not use the appliance if it has been dropped, if there are visible signs of damage or if it is leaking.
- Do not use the appliance for anything other than its intended use.
- Do not use any accessories other than those supplied.
- Do not use any damaged accessories.
- Do not store the appliance in direct sunlight or in high humidity conditions.
- Do not place boiling water or very hot liquid in the appliance.
- Do not dry blend ingredients; always add a small amount of liquid.

- Do not overload the appliance as the mixture level may rise during blending.
- Do not touch any moving parts on this appliance during use, as this could cause injury.
- Do not touch any sections of the appliance that may become hot during use, as this could cause injury.
- Do not use broken or loose cutting or rotating blades.
- Switch off the appliance and disconnect it from the mains power supply before changing or fitting accessories.
- Always unplug the appliance after use and before any cleaning or user maintenance.
- Always use the appliance on a stable, heat-resistant surface, at a height that is comfortable for the user.
- Use of an extension cord with the appliance is not recommended.
- This appliance should not be operated by means of an external timer or separate remote control system, other than that supplied with this appliance.
- This appliance is intended for domestic use only. It should not be used for commercial purposes.



**WARNING:** Do not touch sharp blades.

## Care and maintenance

**STEP 1:** Switch off and unplug the blender from the mains power supply before performing any cleaning or user maintenance.

**STEP 2:** Wipe the blender unit with a soft, damp cloth and allow to dry thoroughly.

**STEP 3:** Wash all of the accessories in warm, soapy water, then rinse and dry thoroughly.

Never touch the chopping blades, shredding tool or slicing tool; using extreme caution, clean the blades with a brush and dry carefully.

Do not use harsh or abrasive detergents or scourers to clean the blender, as this could cause damage.



**NOTE:** The blender should be cleaned after every use.



**WARNING:** Handle the attachments with care as the blades, shredding blade tool and slicing blade tool are sharp. Exercise caution when attaching, removing, cleaning, or storing the attachments.

## Instructions for use

### Before first use

Before connecting to the mains power supply, clean the blender following instructions outlined in the section entitled '**Care and maintenance**'.



**NOTE:** When using the blender for the first time, a slight odour may be emitted. This is normal and will soon subside. Allow for sufficient ventilation around the blender.

## Using the blender set

All attachments must be securely fitted before use; do not attempt to remove them until the attachment has stopped moving.

### With the chopping blade

The chopping blade is ideal for chopping and mixing ingredients for meal preparation.

**STEP 1:** Before connecting the blender to the mains power supply, carefully attach the chopping blade onto the spindle on the inside of the processor bowl. Push down and twist the chopping blade until it clicks into place.

**STEP 2:** Place the food to be chopped into the processor bowl. Secure the processor bowl lid by placing it on top, aligning the guides and then twisting it in until it locks. Ensure the food pusher is placed in the feeding chute before use.

**STEP 3:** To attach the blender unit, place it onto the processor bowl lid coupling and secure by twisting it to lock it in place.

**STEP 4:** Plug in and switch on the blender at the mains power supply.

**STEP 5:** Holding the processor bowl steady, press and hold the desired speed button on the blender unit.

**STEP 6:** Once the food has been chopped to the required size, release the speed button and wait for the chopping blade to stop rotating before removing the processor bowl lid.

**STEP 7:** Any extra food may be added to the chopped ingredients at this point by removing the pusher and putting food down the feeding chute. Replace the food pusher before repeating the chopping process.

**STEP 8:** To remove the blender unit from the processor bowl lid, twist the blender in the opposite direction and lift the blender unit away from the lid.

**STEP 9:** To remove the chopping blade, carefully push down and rotate then lift away from the processor bowl.



**CAUTION:** Switch off and unplug the blender from the mains power supply before attempting to remove any food from the processor bowl and before cleaning.

**WARNING:** Do not use the processor bowl if it is cracked or broken. Do not operate the blender when the processor bowl is empty, as this will cause damage to the appliance.

### With the blade disc

The blade disc is ideal for slicing or shredding ingredients for meal preparation.

**STEP 1:** Before connecting the blender to the mains power supply, carefully secure the required blade tool into the blade disc by pushing the tab into one end and pushing down until it clicks securely into place.

**STEP 2:** Carefully attach the blade disc onto the spindle on the inside of the processor bowl by pushing down and twisting until it clicks securely into place.

**STEP 3:** Secure the processor bowl lid by placing it on top, aligning the guides and then twisting it until it locks. Remove the food pusher from feeding chute before use.

**STEP 3:** To attach the blender unit, place it on to the processor bowl lid coupling for the blender on top of the processor bowl lid and secure by twisting it to lock it in place.

**STEP 4:** Plug in and switch on the blender at the mains power supply.

**STEP 5:** Holding the processor bowl steady, place the food in the feeding chute and press and

hold the desired speed button on the blender unit. Only use the food pusher to press the food into the unit.

**STEP 6:** Once the food has been sliced or shredded, release the speed button and wait for the unit to stop rotating before removing the processor bowl lid.

**STEP 7:** To remove the blender unit from the processor bowl lid, twist the blender in the opposite direction and lifting up the blender unit away from the lid. To remove the blade disc, carefully push down and rotate then lift away from the processor bowl. To remove the blade tool, push away near the tab and carefully pull the blade tool away from the blade disc.



**CAUTION:** Handle the slicing blade tool with care when removing from the blade disc. Scan the QR code for hints and tips on how to do this safely.

### With the whisk attachment

The whisk attachment is ideal for mixing light ingredients such as egg whites, cream and instant desserts. It is not suitable for mixing heavier ingredients such as margarine and sugar, as this may cause damage to the appliance.

**STEP 1:** Before connecting the blender to the mains power supply, carefully attach the whisk attachment onto the blender unit by placing the whisk coupling attachment to the blender and twisting it to lock it in place. To insert the whisk, align the tabs with the whisk coupling unit and push to lock it in place.

**STEP 2:** Place the food to be whisked into a mixing jug or bowl, then plug in and switch on the blender at the mains power supply.

**STEP 3:** Insert the whisk attachment into the mixing jug or bowl and then press and hold the desired speed button.

**STEP 4:** Slowly rotate the whisk attachment in a clockwise direction to avoid splashing. Take care to avoid any liquid rising above the top of the whisk attachment wires. Release the speed button once whisking is complete.

**STEP 5:** After use, remove the whisk attachment from the blender unit by twisting the whisk coupling unit in the opposite direction whilst holding the blender main unit and pulling apart. To remove the whisk from the coupling unit gently pull the whisk whilst holding the whisk coupling unit.



**WARNING:** Do not use the whisk attachment to whisk very hot or boiling liquid, as this may cause injury. When placing food into the mixing jug or bowl, take care not to overfill it in order to avoid spillages.

### With the blender attachment

The blender attachment is ideal for blending or mashing cooked vegetables such as potatoes or carrots. It is not suitable for blending hard or uncooked foods, as this will damage the blender attachment.

**STEP 1:** Before connecting the blender to the mains power supply, carefully attach the blender attachment onto the blender unit by placing the attachment on the blender and twisting to lock in place.

**STEP 2:** Place the food to be blended into a mixing jug or bowl, and plug in and switch on the blender at the mains power supply.

**STEP 3:** Insert the blender attachment into the mixing jug or bowl and then press and hold the desired speed button.

**STEP 4:** Slowly move the blender attachment up and down in the mixture to blend the food evenly. Release the speed button once blending is complete.

**STEP 5:** After use, remove the blender attachment from the blender unit by twisting the attachment in the opposite direction while holding the blender attachment and pulling them apart.



**NOTE:** Whilst mixing liquid, especially hot liquid, use a tall container or blend small quantities at a time to reduce spillage, splattering and the possibility of injury from scalding.



**WARNING:** Do not use the blender attachment to blend very hot or boiling liquid, as this may cause injury. When placing food into a mixing jug or bowl, take care not to overfill it in order to avoid spillages when blending.

## Troubleshooting

Problem	Possible cause	Solution
The blender will not operate.	The blender is not connected to the mains power supply.	Plug in and switch on the blender at the mains power supply.
The attachments will not move when in contact with ingredients.	The ingredients are hard vegetables such as potato, carrot and turnip, making it difficult for the blender to blend.	Only blend ingredients such as cooked vegetables or soft fruit.

## Storage

Check that the blender is cool, clean and dry before storing in a cool, dry place. Never wrap the cord tightly around the blender; wrap it loosely to avoid causing damage.

## Specifications

Product code: EK5877

Input: 220–240 V ~ 50–60 Hz

Output: 1500 W



#### Disposal of Waste Batteries and Electrical and Electronic Equipment



This symbol on the product, its batteries or its packaging means that this product and any batteries it contains must not be disposed of with household waste. Instead, it is the user's responsibility to hand this over to an applicable collection point for the recycling of batteries and electrical and electronic equipment. This separate collection and recycling will help to conserve natural resources and prevent potential negative consequences for human health and the environment due to the possible presence of hazardous substances in batteries and electrical and electronic equipment, which could be caused by inappropriate disposal. Some retailers provide take-back services which allow the user to return exhausted equipment for appropriate disposal. **It is the user's responsibility to delete any data on electrical and electronic equipment prior to disposal.** For more information about where to drop batteries, electrical and electronic waste off, please contact the local city/municipality office, household waste disposal service, or the retailer.

Manufactured by:  
Ultimate Products UK Ltd.,  
Victoria Street, Manchester OL9 0DD. **UK.**  
Ultimate Products Europe Ltd.,  
19 Baggot Street Lower, Dublin DO2 X658. **ROI.**

**MADE IN CHINA.**

CD101023/MD000000/V1