

SimpliMow 320  
SimpliMow 320 V

Art. 9706375-01  
Art. 9706376-01

**en** **Operator's manual**  
Electric Lawnmower

---



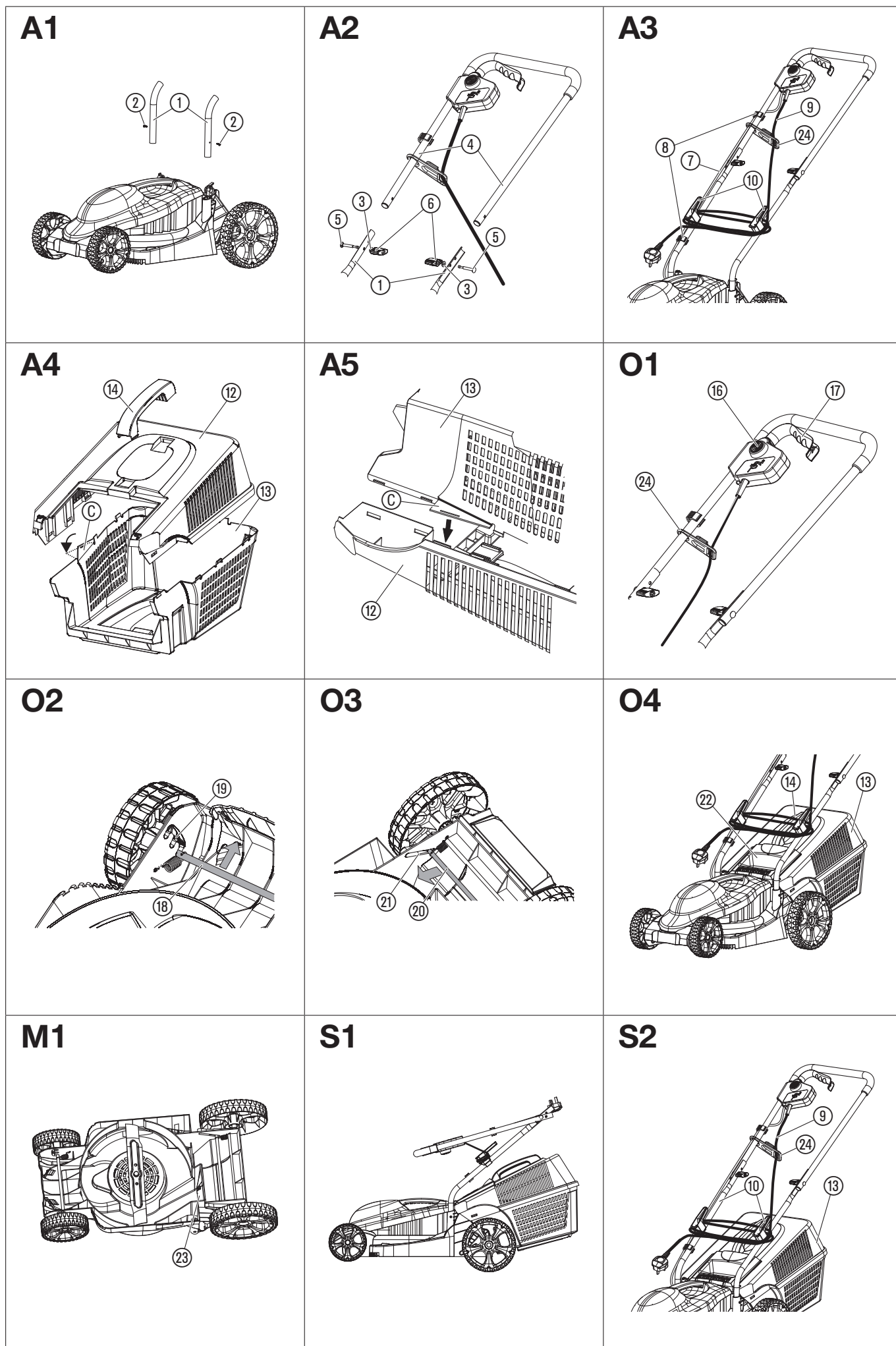

## en Electric Lawnmower

1. SAFETY WARNINGS	4
2. ASSEMBLY	5
3. OPERATION	5
4. MAINTENANCE	6
5. STORAGE	6
6. TROUBLESHOOTING	7
7. TECHNICAL DATA	7
8. ACCESSORIES/SPARE PARTS	7
9. SERVICE/WARRANTY	7
10. DISPOSAL	8

Original instructions.

## 1. SAFETY WARNINGS

### 1.1 Explanation of the symbols:



Read operator's manual.



WARNING – Beware of thrown objects – keep bystanders away.



WARNING – Remove plug from mains before maintenance or if cord is damaged.



WARNING – Keep the supply cord away from the blades.



WARNING – Keep hands and feet away from the blades. Blades continue to rotate after the motor is switched off.

### 1.2 General safety warnings

#### 1.2.1 General machine safety warnings



**WARNING!**

Read all safety warnings, instructions, illustrations and specifications provided with this machine. Failure to follow all instructions listed below may result in electric shock, fire and/or serious injury.

Save all warnings and instructions for future reference.

The term "machine" in the warnings refers to your mains operated (corded) machine or battery operated (cordless) machine.

#### 1) Work area safety

- Keep work area clean and well lit. Cluttered or dark areas invite accidents.
- Do not operate machines in explosive atmospheres, such as in the presence of flammable liquids, gases or dust. Machines create sparks which may ignite the dust or fumes.
- Keep children and bystanders away while operating a machine. Distractions can cause you to lose control.

#### 2) Electrical safety

- Machine plugs must match the outlet. Never modify the plug in any way. Do not use any adapter plugs with earthed (grounded) machines. Unmodified plugs and matching outlets will reduce risk of electric shock.
- Avoid body contact with earthed or grounded surfaces, such as pipes, radiators, ranges and refrigerators. There is an increased risk of electric shock if your body is earthed or grounded.
- Do not operate the lawnmower in rain or wet conditions. This may increase the risk of electric shock.
- Do not abuse the cord. Never use the cord for carrying, pulling or unplugging the machine. Keep cord away from heat, oil, sharp edges or moving parts. Damaged or entangled cords increase the risk of electric shock.
- When operating a machine outdoors, use an extension cord suitable for outdoor use. Use of a cord suitable for outdoor use reduces the risk of electric shock.
- If operating a machine in a damp location is unavoidable, use a residual current device (RCD) protected supply. Use of an RCD reduces the risk of electric shock.

#### 3) Personal safety

- Stay alert, watch what you are doing and use common sense when operating a machine. Do not use a machine while you are tired or under the influence of drugs, alcohol or medication. A moment of inattention while operating machines may result in serious personal injury.

- Use personal protective equipment. Always wear eye protection. Protective equipment such as a dust mask, non-skid safety shoes, hard hat, or hearing protection used for appropriate conditions will reduce personal injuries.
- Prevent unintentional starting. Ensure the switch is in the OFF-position before connecting to power source and/or battery pack, picking up or carrying the machine. Carrying machines with your finger on the switch or energising machines that have the switch on invites accidents.
- Remove any adjusting key or wrench before turning the machine on. A wrench or a key left attached to a rotating part of the machines may result in personal injury.
- Do not overreach. Keep proper footing and balance at all times. This enables better control of the machine in unexpected situations.
- Dress properly. Do not wear loose clothing or jewellery. Keep your hair and clothing away from moving parts. Loose clothes, jewellery or long hair can be caught in moving parts.
- If devices are provided for the connection of dust extraction and collection facilities, ensure these are connected and properly used. Use of dust collection can reduce dust-related hazards.
- Do not let familiarity gained from frequent use of machines allow you to become complacent and ignore machine safety principles. A careless action can cause severe injury within a fraction of a second.

#### 4) Machine use and care

- Do not force the machine. Use the correct machine for your application. The correct machine will do the job better and safer at the rate for which it was designed.
- Do not use the machine if the switch does not turn it on and off. Any machine that cannot be controlled with the switch is dangerous and must be repaired.
- Disconnect the plug from the power source and/or the battery pack from the machine before making any adjustments, changing accessories, or storing machines. Such preventive safety measures reduce the risk of starting the machine accidentally.
- Store idle machines out of the reach of children and do not allow persons unfamiliar with the machine or these instructions to operate the machine. Machines are dangerous in the hands of untrained users.
- Maintain machines. Check for misalignment or binding of moving parts, breakage of parts and any other condition that may affect the machine's operation. If damaged, have the machine repaired before use. Many accidents are caused by poorly maintained machines.
- Keep cutting tools sharp and clean. Properly maintained cutting tools with sharp cutting edges are less likely to bind and are easier to control.
- Use the machine, accessories and tool bits etc. in accordance with these instructions, taking into account the working conditions and the work to be performed. Use of the machine for operations different from those intended could result in a hazardous situation.
- Keep handles and grasping surfaces dry, clean and free from oil and grease. Slippery handles and grasping surfaces do not allow for safe handling and control of the machine in unexpected situations.

#### 5) Service

Have your machine serviced by a qualified repair person using only identical replacement parts.

This will ensure that the safety of the machine is maintained.

#### 1.2.2 Lawnmower safety warnings

- Do not use the lawnmower in bad weather conditions, especially when there is a risk of lightning. This decreases the risk of being struck by lightning.
- Thoroughly inspect the area for wildlife where the lawnmower is to be used. Wildlife may be injured by the lawnmower during operation.
- Thoroughly inspect the area where the lawnmower is to be used and remove all stones, sticks, wires, bones, and other foreign objects. Thrown objects can cause personal injury.
- Before using the lawnmower, always visually inspect to see that the blade and the blade assembly are not worn or damaged. Worn or damaged parts increase the risk of injury.
- Before use, check the supply cord and any extension cord for signs of damage or aging. Do not use the lawnmower if the cord is damaged or worn. If the cord is damaged or worn during use, switch off the lawnmower and do not touch the cord before disconnecting it from the supply. A damaged supply cord or extension cord may result in electric shock, fire and/or serious injury.
- Check the grass box frequently for wear or deterioration. A worn or damaged grass box may increase the risk of personal injury.
- Keep guards in place. Guards must be in working order and be properly mounted. A guard that is loose, damaged, or is not functioning correctly may result in personal injury.
- Keep all cooling air inlets clear of debris. Blocked air inlets and debris may result in overheating or risk of fire.
- While operating the lawnmower, always wear non-slip and protective footwear. Do not operate the lawnmower when barefoot or wearing open sandals. This reduces the chance of injury to the feet from contact with the moving blade.
- While operating the lawnmower, always wear long trousers. Exposed skin increases the likelihood of injury from thrown objects.
- Do not operate the lawnmower in wet grass. Walk, never run. This reduces the risk of slipping and falling which may result in personal injury.

**l) Do not operate the lawnmower on excessively steep slopes.**

*This reduces the risk of loss of control, slipping and falling which may result in personal injury.*

**m) When working on slopes, always be sure of your footing, always work across the face of slopes, never up or down and exercise extreme caution when changing direction.** *This reduces the risk of loss of control, slipping and falling which may result in personal injury.*

**n) Use extreme caution when reversing or pulling the lawnmower towards you. Always be aware of your surroundings.** *This reduces the risk of tripping during operation.*

**o) Keep the supply cord away from the cutting blades.** *A damaged supply cord may result in electric shock, fire and/or serious injury.*

**p) Switch off and remove plug from mains if the cord is entangled or damaged.** *Entangled or damaged cords can increase the risk of electric shock.*

**q) Do not touch blades and other hazardous moving parts while they are still in motion.** *This reduces the risk of injury from moving parts.*

**r) When clearing jammed material or cleaning the lawnmower, make sure all power switches are off and the power cord is disconnected.** *Unexpected operation of the lawnmower may result in serious personal injury.*

### 1.3 Additional safety warnings

#### 1.3.1 Intended use:

The **FLYMO Lawnmower** is intended to mow lawn in private domestic gardens and allotments.

The product is not intended for long term use (professional use).



**DANGER!**

**Personal injury!**

→ Do not use the product to cut bushes, hedges, shrubs, to cut off climbers or grass on roofs or balcony boxes, to chop up branches, twigs and to level irregularities in the soil.

→ Do not use the product on a slope steeper than 20° maximum.

#### 1.3.2 Additional electrical safety warnings



**DANGER!**

**Cardiac arrest!**

This product makes an electromagnetic field while it operates. This field may under some conditions interfere with active or passive medical implants. To decrease the risk of conditions that can possibly injure or kill, we recommend persons with medical implants to speak with their physician and the medical implant manufacturer before you operate the product.

→ Do not use in explosive environment.

→ Do not operate the product in rain or wet conditions.

*This may increase the risk of electric shock.*

#### 1.3.3 Additional personal safety warnings



**DANGER!**

**Risk of suffocation!**

Small parts can be easily swallowed. There is also a risk that the polybag can suffocate toddlers.

→ Keep toddlers away when you assemble the product.

→ Do not cut grass by pulling the machine towards you.

→ Keep the air inlets clean with a brush before storage.

→ Do not reach through openings while using the mower.

→ Disabled or weak persons should ask a second person for help with the transport (weight).

→ Do not disassemble the product further than the delivery status.

→ Use gloves, wear slip resistant shoes and wear eye protection.

→ Only start the mower with an upright standed handle.

→ Do not overload the mower.

→ Never operate the product when you are tired, ill or under the influence of alcohol, drugs, or medicine.

## 2. ASSEMBLY



**DANGER! Risk of injury!**

**Cut injury when the blade turns or the product starts accidentally.**

→ Wait for the blade to stop, disconnect the product from the mains and use gloves before you do assembly.

### 2.1 To connect the lower handles [Fig. A1]:

1. Put both lower handles ① in the product.
2. Make sure that the handles are fully in place and the handle hole is in line with the threaded hole.
3. Put both screws ② in the threaded holes in the product.
4. Tighten the screws ②.

### 2.2 To connect the upper handle [Fig. A2]:

1. Put the upper handle ④ on the lower handles ①.
2. Make sure that the handles are fully in place and the handle holes are inline.
3. Push the screws ⑤ through the holes.
4. Put the washers ③ and the wing nuts ⑥ on the screws ⑤.
5. Tighten the wing nuts ⑥.

### 2.3 To fix the cables to the handles [Fig. A3]:

1. Fix the motor cable ⑦ to the handles with the cable clips ⑧.
2. Tie the mains cable ⑨ around the cable hooks ⑩.

### 2.4 To assemble the grass box [Fig. A4/A5]:

1. Turn the connector ① to the outside.
2. Push the cover ⑫ on the grass box ⑬ until the connections clicks. *Make sure that all connections are connected.*
3. Push the handle ⑭ into the cover ⑫ until it clicks.

## 3. OPERATION



**DANGER!**

**Cutting injury due to the blade!**

Risk of cut injury due to accidental starting.

→ Use gloves.

→ Wait for the blade to stop.



**DANGER! Risk of injury!**

**Cut injury when the blade turns or the product starts accidentally.**

Wait for the blade to stop, disconnect the product from the mains and use gloves before you connect or transport the product.

**Important!**

→ Use a residual current device (RCD) with a rated residual operating current of 30 mA or less.

### 3.1 To connect the mower [Fig. O1]:



**DANGER! Electric shock!**

**To avoid damage to the mains cable ⑨ it must be inserted into the cable lock ⑭.**

→ Before you operate insert the mains cable ⑨ into the cable lock ⑭.

1. Loop the mains cable ⑨, insert the loop into the cable lock ⑭ and pull tight.
2. Connect the mains cable ⑨ into a 230 V mains socket.

### 3.2 To start and stop the mower [Fig. O1]:



**DANGER! Risk of injury!**

**Risk of injury if the product does not stop when the start lever is released.**

→ Do not bypass the safety devices or switches. For example do not attach the start lever ⑰ to the handle.

#### 3.2.1 To start:

The product is fitted with a two-handed safety device (start lever ⑰ with safety interlock ⑱) to prevent the product from being turned on by accident. Contact the FLYMO service if this is not guaranteed.

1. Push the safety interlock ⑱ with one hand and pull the start lever ⑰ with the other hand.
2. Release the safety interlock ⑱. *The product will start.*

### 3.2.2 To stop:

→ Release the start lever ⑰.

### 3.3 To adjust the cutting height [Fig. O2/O3]:



#### **DANGER! Risk of injury!**

#### **Cut injury when the front and rear axles are adjusted in different height positions.**

- Adjust the front and rear axles in the same height position.
- Adjust the front axle in the same height position on both sides.

The cutting height can be adjusted in 3 height positions (2 cm, 4 cm and 6 cm).

1. Lay the product on its side carefully.
2. Pull the front wheel axle ⑯ out of the current height adjust openings ⑱.
3. Release the front wheel axle ⑯ in the new height adjust openings ⑲.  
*Make sure that the front axle is fully released on both sides in the same height position.*
4. Pull the rear wheel axle ⑳ out of the current height adjust opening ㉑.
5. Release the rear wheel axle ⑳ in the new height adjust opening ㉒.  
*Make sure that the rear axle is fully released in the height adjust opening.*

### 3.4 To use the mower with the grass box [Fig. O4]:



#### **DANGER! Risk of injury!**

#### **Cut injury when the blade turns or the product starts accidentally.**

- Wait for the blade to stop, disconnect the product from the mains and use gloves before you open the protective flap ㉓.
- Do not put your hands in the discharge opening.

#### **Do not use the product without grass box.**

1. Lift the protective flap ㉓.
2. Put the grass box ㉔ into the product by the handle ⑭.  
*Make sure that the grass box is securely connected.*
3. Start the product.
4. Stop the product when the grass box ㉔ is completely filled.
5. Lift the protective flap ㉓.
6. Remove the grass box ㉔ of the product by the handle ⑭.
7. Empty the grass box.

### 3.5 Tips to use the mower:

- If grass residue is left in the discharge opening, pull the mower backwards about 1 m so that the grass residue can drop out downwards.
- To produce a well-maintained lawn, we recommend to cut the lawn regularly once a week if possible. The lawn becomes denser if you cut it frequently.
- After relatively long cutting intervals (holiday lawn), first of all cut in one direction with the highest cutting height and then cut in the crosswise direction with the required cutting height.
- If possible, only cut the grass when it is dry, if the grass is damp, the cutting pattern will be uneven.

## 4. MAINTENANCE



#### **DANGER! Cutting injury due to the blade!**

#### **Risk of cut injury due to accidental starting.**

- Use gloves.
- Wait for the blade to stop.

#### **Maintenance and servicing instructions**

- Stop the cutting means if the machine has to be tilted for transportation, when crossing surfaces other than grass and when transporting the machine to and from the area to be used.

- Do not tilt the machine when switching on the motor, except if the machine has to be tilted for starting. In this case, do not tilt it more than absolutely necessary and lift only the part which is away from the operator.
- Stop the machine, and remove plug from the socket, and make sure that all moving parts have come to a complete stop:
  - after striking a foreign object, inspect the machine for damage and make repairs before restarting and operating the machine
  - if the machine starts to vibrate abnormally, immediately inspect for damage, replace or repair any damaged parts and check for and tighten any loose parts
- **Maintain the mower at regular intervals.** This will extend the working life of the mower.
- Only use spare parts recommended by **FLYMO**. This is the only way to ensure safe use of the mower.
- Be careful during adjustment of the machine to prevent entrapment of the fingers between moving cutting means and fixed parts of the machine.
- When servicing the cutting means be aware that, even though the power source is switched off, the cutting means can still be moved.

#### **We recommend to wear a hearing protection.**

### 4.1 To clean the mower:



#### **DANGER!**

#### **Risk of injury!**

Risk of injury and risk of damage to the product.

- Do not clean the product with water or with a water jet (in particular high-pressure water jet).
- Do not clean with chemicals including petrol or solvents. Some can destroy critical plastic parts.

#### **The airflow slots must always be clean.**

→ Clean the overside and underside of the mower after each use.

#### **4.1.1 To clean the overside of the mower and the grass box:**

1. Clean the overside with a damp cloth.
2. Clean the airflow slots and the grass box with a soft brush (do not use sharp objects).

#### **4.1.2 To clean the underside of the mower [Fig. M1]:**

1. Lay the mower on its side carefully.
2. Clean the underside, the blade and the discharge opening ㉓ with a soft brush (do not use sharp objects).

## 5. STORAGE

### 5.1 To store the mower [Fig. S1/S2]:

- The product must be stored away from children.
- Stop the cutting means if the machine has to be tilted for transportation, when crossing surfaces other than grass and when transporting the machine to and from the area to be used.
- Always allow the machine to cool down before storing.



#### **DANGER! Electric shock!**

#### **To avoid damage disconnect the mower from the mains socket.**

1. Disconnect the mains cable ⑨ from the mains socket.
2. Loop the cable ⑨ around the two cable hooks ⑬ and pull it tight.
3. Empty the grass box.
4. Clean the mower (see 4. MAINTENANCE).
5. Store the mower in a dry, enclosed and frost-free place.

## 6. TROUBLESHOOTING



### DANGER!

#### Cutting injury due to the blade!

Risk of cut injury due to accidental starting.

→ Use gloves.

→ Wait for the blade to stop.

### 6.1 To replace the blade:



### DANGER!

#### Risk of injury!

Risk of cutting injuries if a damaged or bent knife or one with unbalanced or chipped cutting edges rotates.

→ Do not use the mower when the blade is damaged, bent, out of balance or has chipped edges.

→ Do not regrind the blade.

The **FLYMO spare parts** are available from your **FLYMO dealer** or from the **FLYMO service**.

→ Only use an original **FLYMO Replacement blade** Art. FLY 085

Let the blade be replaced by the FLYMO Service or a specialist dealer authorized by FLYMO.

### 6.2 Troubleshooting table:

Problem	Possible Cause	Remedy
<b>Mower does not start</b>	Extension cable is disconnected or damaged.	→ Connect the extension cable or if necessary replace it.
	Supply cord is damaged.	→ Let the supply cord be replaced by the <b>FLYMO</b> service or a specialist dealer authorised by <b>FLYMO</b> .
<b>Motor is blocked</b>	Obstacle blocks the motor.	→ Remove the obstacle.
	Cutting height is too low.	→ Increase the cutting height.
<b>Loud noises, the mower is rattling</b>	Screws on motor, its fixing or on the mower chasing are loose.	→ Let the screws be tightened by an authorised specialist dealer or the <b>FLYMO</b> service.
<b>Mower runs unevenly or vibrates strongly</b>	Blade is damaged or worn.	→ Let the blade be replaced by the <b>FLYMO</b> service or a specialist dealer authorised by <b>FLYMO</b> .
	Blade bolt is released.	→ Tighten the blade bolt.
	Blade is very dirty.	→ Clean the mower. If this does not solve the problem, contact the <b>FLYMO</b> Service.
<b>Lawn is not cleanly mowed</b>	Blade is blunt or damaged.	→ Let the blade be replaced by the <b>FLYMO</b> service or a specialist dealer authorised by <b>FLYMO</b> .
	Cutting height is too low.	→ Increase the cutting height.

### NOTE:

Repairs must only be done by the **FLYMO** service departments or specialist dealers approved by **FLYMO**.

→ For any other malfunctions please contact the **FLYMO** service department.

## 7. TECHNICAL DATA

Electric Lawnmower	Unit	Value SimpliMow 320 Art. 9706375-01	Value SimpliMow 320 V Art. 9706376-01
<b>Rated power</b>	W	1000	1300
<b>Mains voltage</b>	V	230	230
<b>Mains frequency</b>	Hz	50	50
<b>Speed of rotation cutting blade</b>	rpm	3400	3400
<b>Cutting width</b>	cm	32	32

Electric Lawnmower	Unit	Value SimpliMow 320 Art. 9706375-01	Value SimpliMow 320 V Art. 9706376-01
<b>Cutting height adjustment (3 positions)</b>	cm	2 – 4 – 6	2 – 4 – 6
<b>Volume of grass box</b>	l	30	30
<b>Weight</b>	kg	10.10	10.30
<b>Sound pressure level <math>L_{pA}</math><sup>1)</sup></b> <b>Uncertainty <math>K_{pA}</math></b>	dB (A)	85 3.0	85 3.0
<b>Sound power level <math>L_{WA}</math><sup>2)</sup>;</b> <b>measured/guaranteed</b> <b>Uncertainty <math>K_{WA}</math></b>	dB (A)	90 / 93 1.17	91 / 96 1.37
<b>Hand/arm vibration <math>a_{vhw}</math><sup>1)</sup></b> <b>Uncertainty <math>k_{vhw}</math></b>	m/s <sup>2</sup>	4.5 1.5	4.5 1.5

Measuring process complying with: <sup>1)</sup> EN IEC 62841-4-3 <sup>2)</sup> RL 2000/14/EC / S.I. 2001 No.1701



**NOTE:** The stated vibration emission value has been measured according to a standardised test procedure and can be used for comparison of one electric power tool with another. It can also be used for preliminary evaluation of exposure. The vibration emission value can vary during actual use of the electric power tool depending on the ways in which the machine is used. As a safety measure, you should work with the machine for a maximum of 1 hour without interruption.

## 8. ACCESSORIES/SPARE PARTS

**GARDENA Replacement Blade** As replacement for blunt blade. Art. FLY 085

## 9. SERVICE/WARRANTY

### 9.1 Service:

Please contact the address on the back page.

### 9.2. Warranty statement:

In the event of a warranty claim, no charge is levied to you for the services provided.

Husqvarna UK Ltd. grants a warranty for all original FLYMO new products for two years\*, provided that the devices have been for private use only. This manufacturer's warranty does not apply to products acquired second hand. This warranty includes all significant defects of the product that can be proved to be material or manufacturing faults. This warranty is fulfilled by supplying a fully functional replacement product or by repairing the faulty product sent to us free of charge; we reserve the right to choose between these options. This service is subject to the following provisions:

- The product has been used for its intended purpose as per the recommendations in the operating instructions.
- Neither the purchaser nor a third party has attempted to open or repair the product.
- Only Original FLYMO replacement parts and wear parts have been used for operation.
- Presentation of the receipt.

Normal wear and tear of parts and components (such as blades, blade fixing parts, turbines, light bulbs, V-belts/ toothed belts, impellers, air filters, spark plugs), visual changes, wear parts and consumables are excluded from the warranty.

This manufacturer's warranty is limited to replacement and repair of products in accordance with the abovementioned conditions. The manufacturer's warranty does not constitute an entitlement to lodge other claims against us as a manufacturer, such as for damages. This manufacturer's warranty does **not**, of course, affect statutory and contractual warranty claims against the dealer/retailer.

The manufacturer's warranty is governed by the law of the Federal Republic of Germany.

In case of a warranty claim, please return the faulty product, together with a copy of the receipt and a description of the fault, with postage paid to the service address.

(\* Upon register)

### 9.3 Consumables:

The blade and the wheels are consumables and are not included in the warranty.

## 10. DISPOSAL

---

### **Disposal of the mower**

*(according to Directive 2012/19/EU/S.I. 2013 No. 3113):*



The product must not be disposed of to normal household waste.  
It must be disposed of in line with local environmental regulations.

### **IMPORTANT!**

→ Dispose of the product through or via your local recycling collection centre.

---



## PRODUCT LIABILITY



---

In accordance with the German Product Liability Act, we hereby expressly declare that we accept no liability for damage incurred from our products where said products have not been properly repaired by a FLYMO-approved service partner or where original FLYMO parts or parts authorised by FLYMO were not used.

## EC DECLARATION OF CONFORMITY

---

The undersigned hereby certifies as the authorized representative of the manufacturer, Husqvarna AB, 561 82 Huskvarna, Sweden, that, when leaving our factory, the unit(s) indicated below is/are in accordance with the harmonised EU guidelines, EU standards of safety and product specific standards. This certificate becomes void if the unit(s) is/are modified without our approval.

Description of the product:	<b>Electric Lawnmower</b>	
Product type:	<b>SimpliMow 320 SimpliMow 320 V</b>	
Article number:	<b>9706375-01 9706376-01</b>	
CE-Directives:	<b>2014/30/EU 2011/65/EU 2006/42/EC 2000/14/EC</b>	
Harmonised EN:	<b>EN ISO 12100 EN 62841-1 EN IEC 62841-4-3</b>	
Deposited documentation:	<b>GARDENA Technical Documentation M. Jäger Hans-Lorenser-Str. 40 D-89079 Ulm</b>	
Conformity assessment according to:	<b>2000/14/EC Procedure: art. 14 Annex VI</b>	
Noise level: measured / guaranteed	<b>9706375-01 9706376-01</b>	<b>90 dB(A) / 93 dB(A) 91 dB(A) / 96 dB(A)</b>
Year of CE marking:	<b>2022</b>	
Ulm, 01.10.2022 Authorised representative:	 <b>Reinhard Pompe</b> Vice President Products	 <b>Wolfgang Engelhardt</b> Vice President Supply Chain

# UKCA DECLARATION OF CONFORMITY

The manufacturer: Husqvarna AB SE 561 82 Huskvarna, Sweden hereby certifies, when leaving our factory, the unit(s) indicated below is/are in accordance with the UK Regulations, designated standards of safety and product specific designated standards. This certificate becomes void if the units are modified without our approval.

Description of the product: **Electric Lawnmower**

Product type: **SimpliMow 320  
SimpliMow 320 V**

Article number: **9706375-01  
9706376-01**

UK regulations: **S.I. 2016/1091  
S.I. 2012/3032  
S.I. 2008/1597  
S.I 2001/1701**

Designated standards: **EN ISO 12100  
EN 62841-1  
EN IEC 62841-4-3**

Conformity assessment body: **DEKRA Testing and Certification GmbH  
Handwerkstraße 15  
70565 Stuttgart**

UK Importer: **Husqvarna UK Limited  
Preston Road  
Aycliffe  
County Durham  
UK DL5 6UP**

Deposited documentation: **GARDENA Technische Dokumentation  
M. Jäger  
Hans-Lorenser-Str. 40  
D-89079 Ulm**

Noise level: measured / guaranteed **9706375-01 90 dB(A) / 93 dB(A)  
9706376-01 91 dB(A) / 96 dB(A)**

Conformity assessment according to: **S.I. 2001/1701 Art. 11 Schedule 9**

Ulm, 01.10.2022

Authorised representative:



**Reinhard Pompe**  
Vice President Products



**Wolfgang Engelhardt**  
Vice President Supply Chain







**Service Address and  
Importer to Great Britain**

Husqvarna UK Ltd  
Preston Road  
Aycliffe Industrial Park  
Newton Aycliffe  
County Durham  
DL5 6UP  
info.FLYMO@husqvarna.co.uk



21320-85.960.01/0922  
Husqvarna AB  
Drottninggatan 2  
SE-561 82 Huskvarna  
Sweden

Our policy of continuous improvement means that the specification of products may be altered from time to time without prior notice.

Copyright © 2022 Flymo S.A. All rights reserved.

Flymo® and other product and feature names are registered or unregistered trademarks of Flymo S.A.